

THIS DOCUMENT IS THE PROPERTY OF BOSTON WHALER, INC. Mfg. DEPT. EDGEWATER, FLORIDA. ALL RIGHTS ARE RESERVED. THIS DOCUMENT AND INFORMATION CONTAINED MUST NOT BE COPIED OR DISCLOSED TO OTHERS WITHOUT WRITTEN PERMISSION OF BOSTON WHALER, INC.

NOTES:

1. SEE DWG. 01-251 FOR HOSE CUT LENGTHS.
2. PUMP LOCATION SEE DWG. 06-151.

REVISIONS					
REV.	DESCR.	BY	DATE	APPVD.	ECN NO.
A	Changed Numbering System/Apply Att.Border.	AVM	03/24/03	ZAC	03-03-13
B	CHANGED PN# & DESCRIPTION ITEMS 16,18 &19	SLJ	06/23/03	ZAC	03-06-31
C	CHANGED PN# & DESCRIPTION ITEM 3, SHEETS 1 & 2	SLJ	04/05/05	ME	05-03-19

SHOWER SPRAYER & WATER INLET
SEE DWG. 09-404 FOR
LOCATION & INSTALLATION

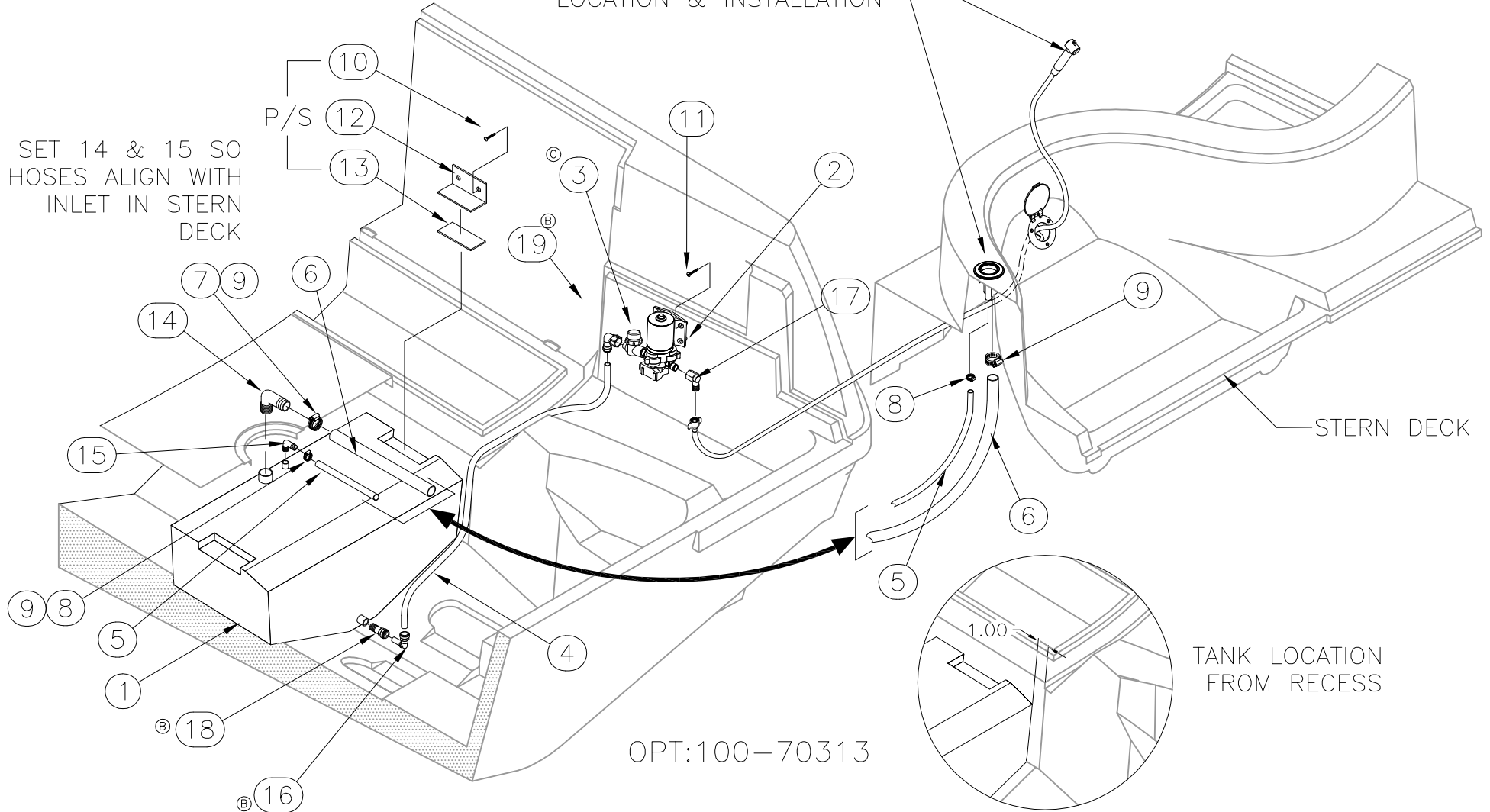

CHECKED: R. DURHAM	DATE: 8/13/01	FILENAME: 067012100R	BOAT MODEL	Mold Number
APPD: R. AVILA	DATE: 8/13/01	DRAWN: RCRAVEN	2100R	
DESIGN: L.SCHOLZ	DATE: 8/19/01	DATE: 08/10/01	SCALE: NONE	
INT. ENG: M. GATICA	DATE: 10/08/01	DWG. TITLE: Fresh Water System Installation	INIT. REL. ECN NO: 01060	DWG. NO: 06701
				SHT. NO. 1 of 2

Parts List				
ITEM	QTY	U/M	DESCRIPTION	B.W.I. NO.
	1	EA.	TANK, WATER 2100R-02 20GAL	1630011
	1	EA.	PUMP, FRESH WATER SHURFLO 2.8GPM IMP	1128164
Ⓒ	1	EA.	FILTER, IN-LINE WATER 1/2"MP SM X 1/2"NPSF	1797944
Ⓑ	0	FT.	TUBING, SEATECH 15MM X 11MM X 250' BLUE	1210160
	0	FT.	HOSE, SANI/CHEMICAL TDX 5/8"	0124719
	0	FT.	HOSE, SANI/SMOOTH WALL 1.5"	0123844
	2	EA.	CLAMP, HOSE #24 1"-2" SS .505	0256693
	2	EA.	CLAMP, HOSE #10 1/2"-1 1/8" SS .505	0263954
	4	EA.	COVER, CLAMP END PROT 1/2"L X .045"X .465"RED	0830968
	4	EA.	SCREW, TAPPING #14A x 1.5" PTH SC	1010909
	4	EA.	SCREW, TAPPING #10A x 2" PTH SC	1008754
	2	EA.	BRACKET, PVC 2"X 2"X 1/4"X 6" BW-01	1547280
	1	FT.	TAPE, FOAM NEOPRENE W/3M 9828 3/8"TH X 2W	1497452
	1	EA.	DRAIN, ELBOW 90DEG 1.5" SHORT THREAD X BARB	1675214
	1	EA.	ELBOW, MARELON 1/2"MPT X 5/8"BARB X 90DEG	0995563
Ⓑ	1	EA.	ELBOW, SEATECH 90DEG STEM 15MM	1214840
Ⓑ	1	EA.	ELBOW, ACETAL 1/2"MPT X 1/2" FPT X 90DEG	0172551
Ⓑ	1	EA.	ADAPTER, SEATECH STRAIGHT 1/2"MPT-15MM	1542919
Ⓑ	1	EA.	FITTING, NEPT 1/2"FEM X 15MM ELB SWVL 90DEG	1453935
	3	GL	ANTI-FREEZE, PROPYLENE GLYCOL	0902395